

CIRCUIT DIAGRAM

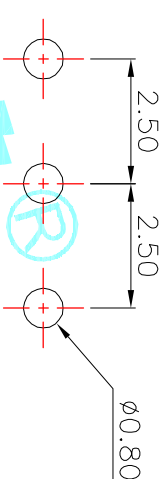

HOLE LAYOUT

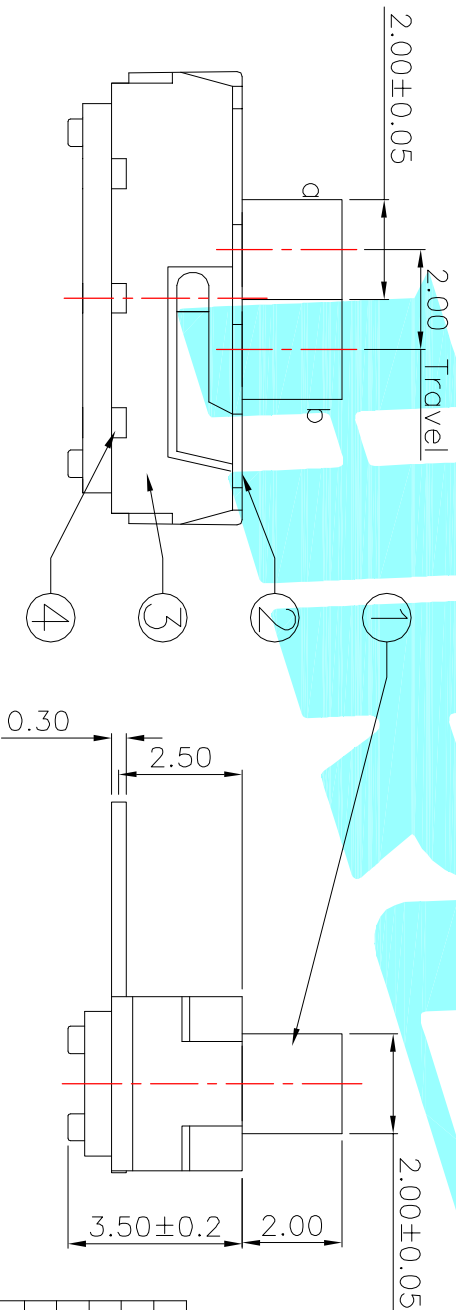

Typical Specifications :
 1. Rating : DC 6V 0.3A
 2. Life:10,000 Cycles Min.
 3. Operating force:190±50gf

ITEM	PART NAME	TER'NO.	QTY.	MATERIAL	FINISHING	REMARK
⑤	Contact Spring	—	1	Beryllium copper	Ag Plated	—
④	Terminal	—	3	Brass Strip	Ag Plated	—
③	Base	—	1	NYLON	Black	—
②	Cover	—	1	SUS	Natural	—
①	KNOB	—	1	NYLON	Black	—

APPROVALS		DATE	TITLE:	
DRAWN	xu qi feng	2014.11.17	TOGGLE SWITCHES	
CHECKED			ELECTRONICS CO.,LTD	
APPROVALS			HROELECTRONICS®	

ECN NO.	REV.	DATE.	DESCRIPTION.	CHANGE.	CHECK.	APPRO.	TOLERANCES ARE	ANGLE	UNIT:	SCALE:	PROJ:	SHEET
	A		NEW				30~12.5 ±	±0.30	mm	1:1	OKHRO	1 OF 1
							10~30 ±	±0.20				
							5~10 ±	±0.15				
							~5 ±	±0.10				

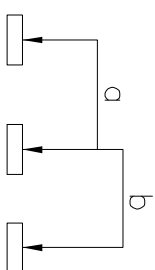
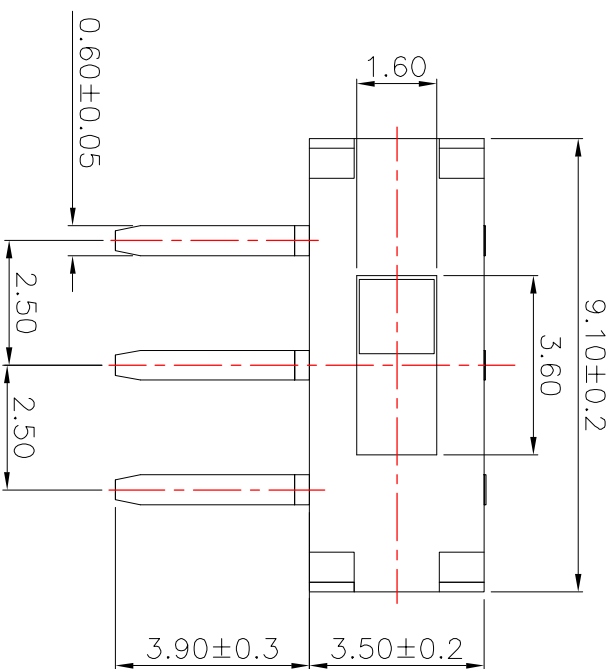

CIRCUIT DIAGRAM

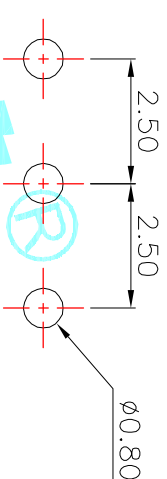

HOLE LAYOUT

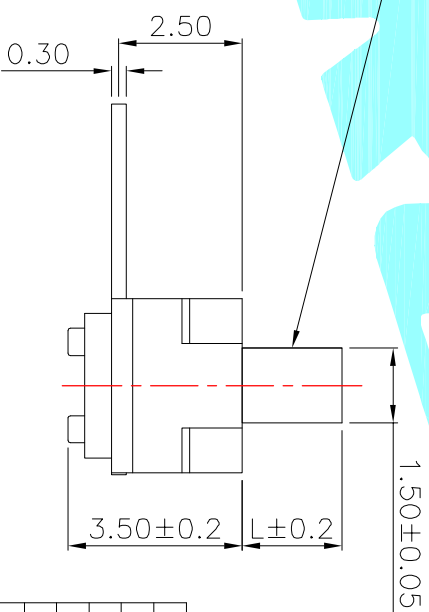
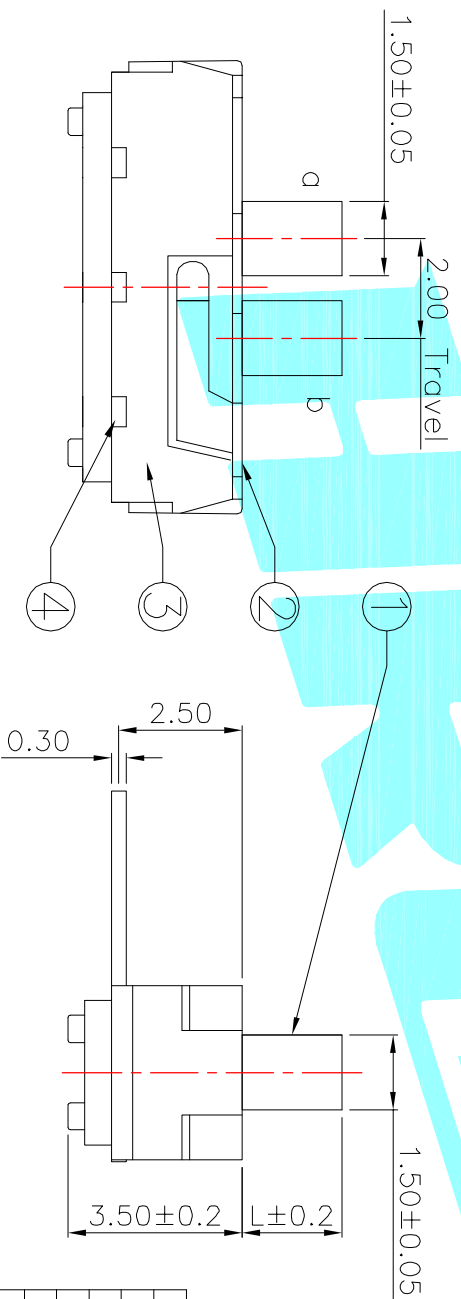

PART NO.	L	Operating force
K3-1260D-F1	2	190±50gf
K3-1260D-K1	3	
K3-1260D-L1	4	
K3-1260D-M1	7	

ITEM	PART NAME	TER'NO.	QTY.	MATERIAL	FINISHING	REMARK
⑤	Contact Spring	—	1	Beryllium copper	Ag Plated	—
④	Terminal	—	3	Brass Strip	Ag Plated	—
③	Base	—	1	NYLON	Black	—
②	Cover	—	1	SUS	Natural	—
①	KNOB	—	1	NYLON	Black	—

APPROVALS	DATE	TITLE:
DRAWN J.X.Zhong	2014/1/22	TOGGLE SWITCHES
CHECKED		ELECTRONICS CO.,LTD

ECN NO.	REV.	DATE.	DESCRIPTION.	CHANGE.	CHECK.	APPRO.
	A		NEW			
TOLERANCES ARE: $30 \sim 12.5 \pm$ ± 0.30 ANGLE $\pm 2'$ UNIT: mm SCALE: 1:1 PROJ: SHEET 1 OF 1						

